

---

# NELS42: DIVERSITY AND UNIVERSALS

*The Role of Typology and Linguistic Universals in Linguistic Theory*



UNIVERSITY OF TORONTO • NOVEMBER 11–13, 2011

---

## GENERAL INFORMATION

---

### CONTENTS

<b>NELS42 orientation map</b> .....	<b>1</b>
<b>Conference locations</b> .....	<b>2</b>
<b>Contact information</b> .....	<b>3</b>
Emergency contacts .....	3
Embassy contact .....	3
<b>Transportation</b> .....	<b>4</b>
Airports.....	4
Taxis .....	4
Public transit (Toronto Transit Commission).....	5
Parking.....	6
<b>Amenities</b> .....	<b>6</b>
Restaurants and cafés.....	7
Copying/printing.....	7
Other services .....	8
<b>Information for presenters</b> .....	<b>8</b>
Travel funding.....	8
Proceedings information (from UMass GLSA) .....	9
<b>Directory of presenters</b> .....	<b>9</b>
<b>Reviewers</b> .....	<b>12</b>
<b>Acknowledgments</b> .....	<b>12</b>

---

#### **A NOTE ON THE TYPE**

The NELS42 materials make use of the **TORONTO SUBWAY** font, which was designed for Toronto's first subway in 1954 and has become a distinctive part of the city's visual identity.

# NELS42 ORIENTATION MAP

## KEY MAP

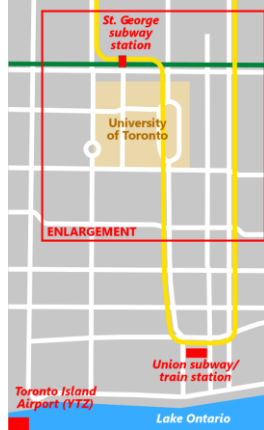

## LEGEND

### TRANSPORTATION

- Yonge-University-Spadina subway line
- Bloor-Danforth subway line
- Dundas** Subway station
- Streetcar/bus route (with stop)

**The Annex** Neighbourhood

### SOCIAL EVENT VENUES

- BS** Bata Shoe Museum (banquet)
- G** GSU café/pub (grad mixer)

### CONFERENCE VENUES

- SS** Sidney Smith Hall (Thursday evening check-in)
- VC** Victoria College & Emmanuel College (Friday until 2:15)
- BA** Bahen Centre (Friday after 2:30, Saturday-Sunday)
- Walking route** from VC to BA

### CONFERENCE HOTELS

- IC** InterContinental
- HI** Holiday Inn
- HJ** Howard Johnson

## CAMPUS AREA MAP *(see following pages for enlargements and floorplans)*



# CONFERENCE LOCATIONS

The conference is taking place in three locations on the U of T campus, shown on the campus map above:

1. *Thursday evening advance check-in, 6:00-9:00pm*  
**SS: Linguistics department, 4th floor, Sidney Smith Hall** (Arts and Science building), 100 St. George Street (south of Harbord Street).
2. *Friday, 8:00am to 2:15pm*  
**VC/EM: Victoria College and Emmanuel College** (140 Charles St. W./75 Queen's Park Cres. E.). These buildings are next to each other, as shown in the following enlargement:

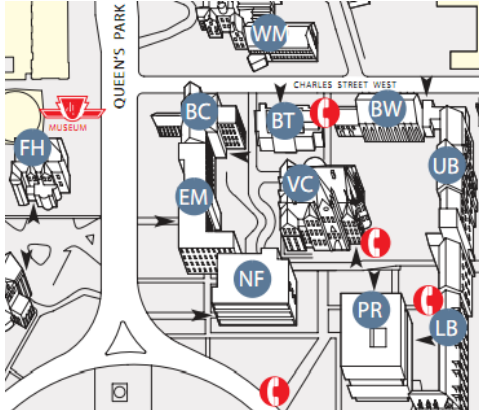

The following floorplans show the NELS meeting rooms in Emmanuel and Victoria Colleges:

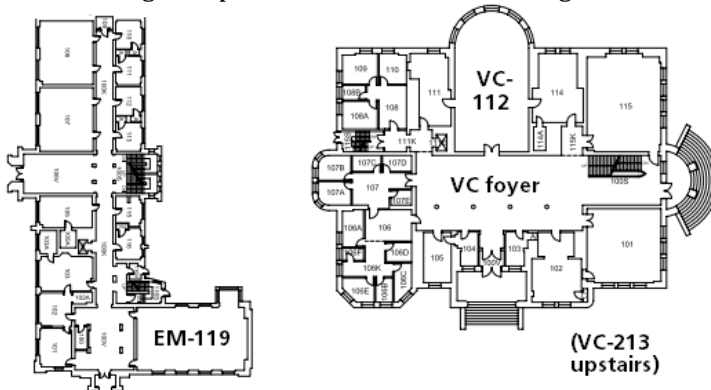

3. *Friday from 2:30pm; all day Saturday and Sunday*  
**BA: Bahen Centre for Information Technology**, 40 St. George Street (north of College Street):

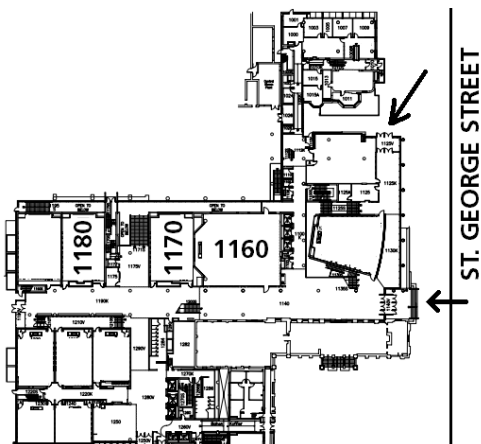

**The walking route between Victoria College and the Bahen Centre** is indicated on the campus area map. The walk will take 15-20 minutes.

It is also possible to make this trip by transit, although the transit trip is unlikely to be faster than walking. Please ask a NELS organizer or volunteer for transit directions if required.

### SOCIAL EVENT LOCATIONS

- The **dinner and party** will take place in the **Bata Shoe Museum**, 327 Bloor Street West (at St. George Street) on Saturday evening from 7:30pm to midnight.
- The **graduate student mixer** will take place in the Graduate Students' Union café/pub, 16 Bancroft Avenue (upstairs), on Friday evening from 7:30pm. Bancroft Avenue is a small laneway that can be accessed from Huron Street, northwest of the Bahen Centre:

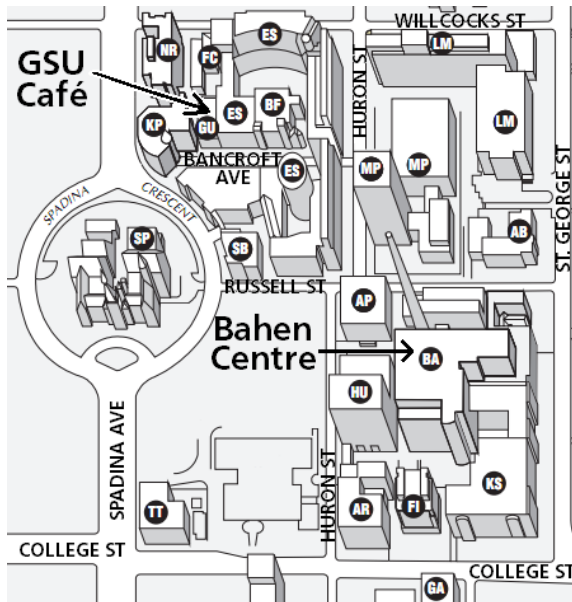

**General orientation tip:** South is the direction in which you can see the CN Tower.

---

## CONTACT INFORMATION

Note that Toronto uses “10-digit dialing”: even local calls must include the area code.

### EMERGENCY CONTACTS

Emergency	911
Police (non-emergency)	416-808-2222
U of T Campus Police	416-978-2222
Poison Control	416-813-5900
Toronto General Hospital	416-340-3948

### EMBASSY CONTACT

Consulate General of the United States  
in Toronto, Canada  
360 University Avenue  
Toronto, ON M5G 1S4  
Phone: 416-595-1700

---

# TRANSPORTATION

## AIRPORTS

Toronto has two international airports: Toronto Pearson Airport (YYZ) and Toronto City Centre Airport (YTZ) (the “Island Airport”).

**Pearson Airport (YYZ)** is located on the western edge of the city and can be accessed by taxi or transit. The trip is quicker by taxi than by transit, but is more expensive (and more vulnerable to traffic delays).

### BY TAXI:

- Taxis *leaving* Pearson charge a flat-rate zonal fare; to the campus area, the rate is \$54. Taxis *going to* Pearson charge the regular meter rate (see Taxis section below).
- The taxi ride will take around 45 minutes, depending on traffic (longer in rush hour).

### BY TRANSIT:

- The **192 Airport Rocket** bus provides an express service between Pearson Airport and Kipling subway station, where a free transfer can be made onto the subway for travel downtown.
- The 192 stops at both terminals at Pearson (Terminals 1 and 3; there is no Terminal 2). The bus departs approximately every 10 minutes until midnight and less frequently until 2am.
- Note that buses from other cities also serve the airport; the stop for Toronto buses is marked by a red-and-white sign.
- Transit fare is \$3 (exact change). A fare vending machine that accepts credit cards is located inside **Terminal 1** near the bus stop. (If you arrive at Terminal 3, you can take a short ride on the free LINK Train to Terminal 1. To access the train, follow signs for “Terminal 1”.)
- The bus ride to Kipling subway station is approximately 20-25 minutes and the subway trip downtown will take another 25 minutes. All trains from Kipling station go downtown.
- Full details can be found at [http://www3.ttc.ca/Riding\\_the\\_TTC/Airport\\_service.jsp](http://www3.ttc.ca/Riding_the_TTC/Airport_service.jsp)

The **Island Airport (YTZ)** is located on an island in the harbour, adjacent to downtown. A free 2-minute ferry ride connects the airport to the mainland. You have a variety of options to get from the airport to your destination:

- Taxis are available just outside the ferry dock.
- A free express shuttle bus to the centre of the downtown core (a 10-minute trip) departs approximately every 15 minutes. The bus brings you to the side of the Royal York Hotel, just around the corner from Union Station, where you can access the subway.
- The 509 Harbourfront streetcar is a 3-minute walk from the airport (on Queen’s Quay at Bathurst St.) and the 511 Bathurst streetcar is a 7-8-minute walk (on Fleet St. at Bathurst St.).

## TAXIS

Most taxis accept major credit cards (it is best to ask upon entering the taxi) but not debit cards. Toronto taxi rides are usually charged by the kilometre and the minute, following a regulated rate:

*Approximately:* \$4.00 initial charge + \$1.60 per kilometre + \$0.50 per minute

Taxis can easily be hailed on major streets. In the campus area, such streets include Bloor Street, University Avenue, College Street, and Spadina Avenue.

Popular taxi companies in Toronto include:

Beck Taxi	416-751-5555	Diamond Taxi	416-366-6868
City Taxi	416-241-1400	Royal Taxi	416-777-9222
Co-op Taxi	416-504-2667	Yellow Taxi	416-504-4141
Crown Taxi	416-750-7878		

## PUBLIC TRANSIT (TORONTO TRANSIT COMMISSION)

Downtown Toronto, including the campus area, is well-served by frequent public transit. The routes, stations, and stops mentioned below are shown on the campus map on page 1. All TTC vehicles automatically announce each upcoming stop, so you will always know where you are!

SUBWAY: Spadina, St. George, Museum, and Queen's Park stations all border the campus.

- The closest subway station to **Victoria College** (Friday morning sessions) is **Museum**.
- The closest subway station to the **Bahen Centre** (remaining sessions) is **Queen's Park**.
- The closest subway station to the **Bata Shoe Museum** (banquet) is **St. George**. Use the St. George Street exit, not the Bedford Road exit.
- Subway trains run every 2 to 5 minutes from approx. 6am to 1:30am, but **from 9am on Sunday**.

### SUBWAY NETWORK DIAGRAM



### FREQUENT SURFACE ROUTES ON CAMPUS

(Stops are marked by a red-and-white sign on a pole with an icon of a streetcar/bus.)

- The **510 Spadina streetcar** provides an extremely frequent service (approximately every 2 minutes) along Spadina Avenue on the west edge of campus. It can be boarded underground inside the Spadina subway station or from on-street boarding islands on Spadina Avenue.
  - For Victoria College, exit the streetcar inside Spadina subway station and take a **southbound** subway train 2 stops to Museum.
  - For the Bahen Centre, exit the streetcar at the College Street stop and walk 5 minutes east along College Street to St. George Street.
- The **506 Carlton streetcar** runs approximately every 5 minutes along College Street on the south edge of campus.
  - For Victoria College, exit the streetcar at the University Avenue stop and enter Queen's Park subway station; take a northbound train 1 stop to Museum.
  - For the Bahen Centre, exit the streetcar at the St. George Street stop (when travelling westbound) or the Beverley Street stop (when travelling eastbound).
  - When exiting this streetcar, make sure that traffic in the curb lane has stopped.
- The **94 Wellesley bus** runs approximately every 10 minutes along Harbord Street and Hoskin Avenue through the centre of campus.
  - For Victoria College, exit the bus at Queen's Park East (when travelling eastbound) or Queen's Park North (when travelling westbound).
  - For the Bahen Centre, exit the bus at the St. George Street stop and walk south down St. George Street.

## TRANSIT FARES

- Transit fare is **\$3** (cash only, exact change) or \$2.50 if you buy transit tokens in bulk (4 or 8) at a subway station (cash only, change is given).
- A fare is valid for **one journey** of any distance, and you may transfer between subways, streetcars, and buses for free as many times as necessary to reach your destination. Make sure to take a paper transfer when you pay your fare. On a streetcar or bus, get a transfer from the driver; in the subway, use the red transfer-dispensing machines inside the paid area.
- Day passes for unlimited travel can be purchased for \$10 at a subway station. On Saturday or Sunday, two adults together can share a single day pass. If, on these days, two adults are making a return trip together (=4 fares), it is cheaper to buy a day pass than to pay the cash fare.

Visit <http://www.ttc.ca> for full details (maps, trip planner, fares) or call 416-393-4636 (INFO).

## PARKING

We advise that you avoid driving in the campus area and downtown if at all possible, as parking is both expensive and difficult to find, especially on Friday. Here are a few possibilities:

- There is a parking lot on the west side of Huron Street just north of Bloor.
- There is underground parking on Walmer Road just north of Bloor.
- There is parking under Graduate House on Glen Morris Street just east of Spadina.
- There is underground parking below the Quality Hotel Midtown (280 Bloor Street West).

On the weekend, parking is available in some University of Toronto lots for \$6 a day. For details and a map, visit <http://www.parking.utoronto.ca/visitors.htm>.

Some campus streets have metered parking using the “pay and display” system (e.g. St. George Street). Some side streets have free parking, but this is generally limited to one hour. Parking enforcement is strict in the campus area.

## AMENITIES

The major dining and commercial areas near campus are indicated on the map to the left.

The directions on the following pages refer to these areas.

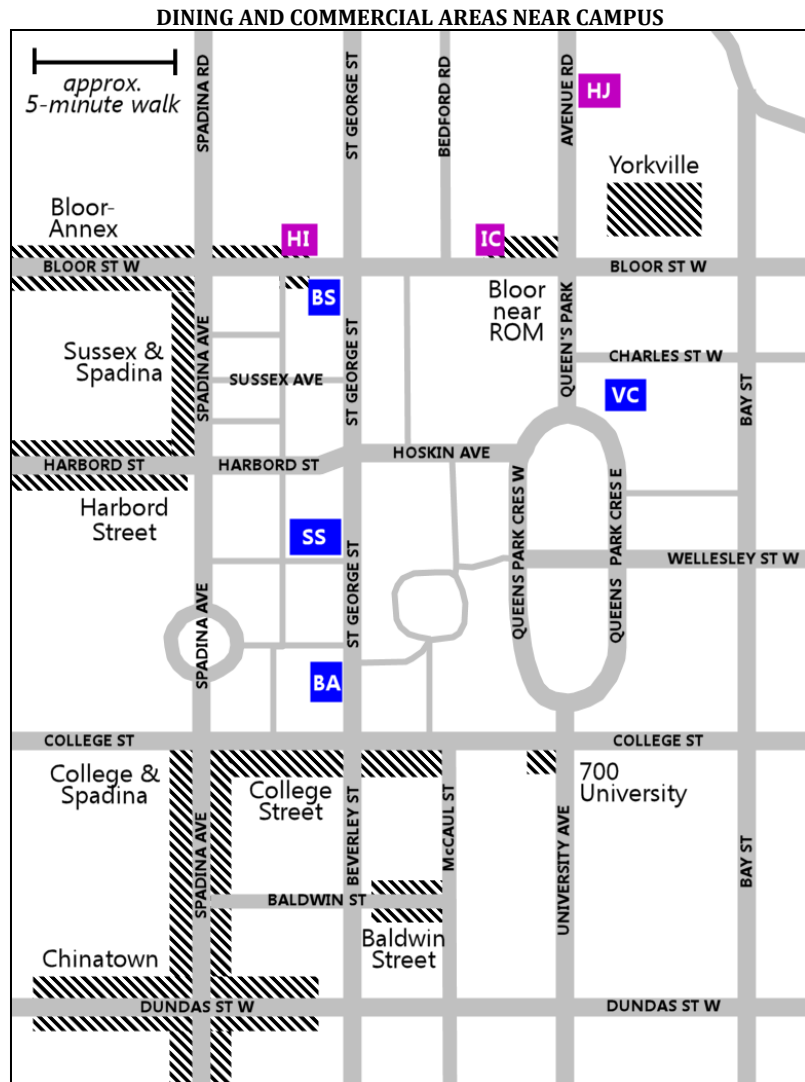

## RESTAURANTS AND CAFÉS

All of the shaded areas in the above map have a high concentration of restaurants. Each area has a different character, so the best place to go depends on what you're looking for:

- **Bloor-Annex:** A diverse strip of sushi places, pubs, pizza places, Thai restaurants, and much more. Also a good destination for bookstores and unique shops.
- **Bloor near ROM (\*\**closest to Victoria College*\*\*):** Across the street from the Royal Ontario Museum is a selection of convenience food – Over Easy Breakfast & Lunch, Quesada Mexican Grill, Subway, Booster Juice, Pho Hung, China Garden, McDonald's, Gabby's Bar and Grill.
- **Yorkville:** A variety of high-end restaurants and cafés.
- **Sussex & Spadina:** Fast food: burgers, subs, and pizza.
- **Harbord Street:** A local destination for nice restaurants; there are approximately 15 restaurants on Harbord Street between Spadina and Borden.
- **College & Spadina:** Fast food (Burger King, Popeye's, Pizza Nova); Chinatown begins as you walk south on Spadina.
- **Chinatown:** More Chinese restaurants than you can count (and other Asian cuisines as well), mostly with extremely reasonable prices. The beginning of Chinatown is approximately an 8-10 minute walk from the Bahen Centre.
- **College Street (\*\**closest fast food to Bahen Centre*\*\*):** Many fast-food restaurants and cafés. There is a Second Cup café at 179 College and a Starbucks at 205 College (at the corner of College and Beverley/St. George, very close to the Bahen Centre).
- **Baldwin Street (\*\**closest nice dining to Bahen Centre*\*\*):** Over 20 diverse restaurants in converted Victorian houses on a quiet, tree-lined street. Approximately a 6-7 minute walk from the Bahen Centre. Walk down St. George Street and then Beverley Street until you get to Baldwin Street; turn left on Baldwin for the restaurants.
- **700 University:** The lower level has a small food court (closed on weekends).

## COPYING/PRINTING

### *Sussex & Spadina*

- **The Copy Place**, 720 Spadina, suite 103. M-F 9-6pm, 5¢/copy.
- **Three Cent Copy Centre**, 732 Spadina. M-F 9-7pm, Sat 11-5pm.

### *Bloor West (near Victoria College)*

- **Print City / Krishna Copy Printing**, 180 Bloor W, inside lobby, downstairs. Posters printed. M-Th 8:30-7pm, F 8:30-6pm, closed Sunday.

### *College Street (near Bahen Centre)*

- **The Printing House**, 700 University at bottom of short flight of steps. M-F 8am-7pm. Posters printed in 4 hours. 5¢ copying. University of Toronto rate available.
- **Image Express**, 193 College. M-F 9-5:30pm, Sat 10-4pm. From 3¢/copy. Posters printed.
- **Alicos Copy Centre**, 203a College. M-Th 9-6:30pm, F 9-6, Sat 11-4. Poster printing \$3.99/sq. ft.
- **Learning Achievement Centre**, 233 College. M-F 10-6pm. Posters printed in 1hr.
- **Printorium Toronto**, 255 College. Th 11-6pm, F 10-6pm, Sat 11-5pm. 5¢/copy.

## OTHER SERVICES

### CONVENIENCE STORES

- *Bloor West*
  - **G's Fine Foods**, 24-hour convenience store, Bloor & Huron (across from Holiday Inn)
  - **International News Plus**, Bloor St. W, west of St. George St.
  - **Shoppers Drug Mart**, Bloor St. W, east of Bedford Rd. (open 8am-midnight)
- *College Street*
  - **College Variety**, 237 College at Huron, southeast corner (\*\*near Bahen Centre\*\*)
  - **7-11**, College & Spadina northeast corner

### BANKS

- *Bloor West*
  - **CIBC** ATM inside 7-11, Bloor & Spadina northwest corner
  - **Scotiabank** branch and ATM, Bloor & Spadina northeast corner
  - **Bank of Montreal** branch and ATM, Bloor & Bedford northeast corner
  - **HSBC Bank Canada**, 150 Bloor W, east of Avenue Road
- *College and Spadina*
  - **Alterna** ATM, south side of College just east of Spadina (exterior of building)
  - **CIBC** branch and ATM, College & Spadina northwest corner, ATM on exterior of building
- *Harbord and Spadina*
  - **Royal Bank** branch and ATM, Harbord & Spadina northwest corner
- *On campus*
  - **Scotiabank** ATM, Sidney Smith Hall, 100 St. George St., 1<sup>st</sup> floor
  - **Royal Bank** ATM, Athletic Centre foyer, Harbord & Spadina
  - **TD** ATM, Robarts Library, Harbord & St. George, 2<sup>nd</sup> floor (by food court)

### PHARMACIES

- **Spadina Medical Remedy's Rx**, 720 Spadina Ave. (north of Sussex), closed Sunday
- **Snowdon Pharmacy**, 264 Bloor St. W (west of St. George St.)
- **Shoppers Drug Mart**, Bloor St. W, east of Bedford Rd. (open 8am-midnight)

### POST OFFICES

- **Post Office, Station P**, 704 Spadina Ave. (north of Sussex)
- **The Depot**, 131 Bloor St. W (east of Avenue Road)
- **University of Toronto Bookstore**, 214 College (at St. George) (\*\*next to Bahen Centre\*\*)
- **Young's Smoke and Variety**, 283 College (just west of Spadina)

### ALCOHOL

- **The Beer Store**, 720 Spadina Ave. (north of Sussex)
- **LCBO (liquor store)**, 337 Spadina Ave. (Spadina and Baldwin, southeast corner)

---

## INFORMATION FOR PRESENTERS

### TRAVEL FUNDING

Our SSHRC grant provides a limited amount of funding to subsidize the transportation and accommodation of **Canadian student presenters** (i.e. student presenters who are Canadian citizens).

- If you would like to make a travel claim, please email [nels42@chass.utoronto.ca](mailto:nels42@chass.utoronto.ca) after the end of the conference for instructions. Remember to keep your hotel receipts and boarding passes.
- Note that we may only be able to provide a **partial reimbursement** of your expenses. The amount of funding per student depends on the number of students who apply to the fund.
- We regret that SSHRC regulations prohibit us from reimbursing non-Canadian students.

## PROCEEDINGS INFORMATION (FROM UMASS GLSA)

Dear presenters,

We are happy to invite submissions for the proceedings volume for NELS 42.  
The deadline for submission is **March 15, 2012**.

The style sheet, as well as a LaTeX template, can be downloaded at  
**<http://glsa.hypermart.net/nels42.html>**.

If you have any questions or concerns, please contact us at **[nels@linguist.umass.edu](mailto:nels@linguist.umass.edu)**.

Best,  
Stefan Keine  
Shayne Sloggett

## DIRECTORY OF PRESENTERS

Presenter	Affiliation	Title
Acedo-Matellán, Víctor	Universitat Autònoma de Barcelona	Conflation vs. incorporation in bare phrase structure
Ahn, Byron T.	UCLA	Giving reflexivity a Voice: Twin reflexives in English
Ahn, Miyeon	University of Michigan	Selective perceptual epenthesis in English to Korean preconsonantal /s/ adaptation
Alboiu, Gabriela	York University	The Case of A-bar ECM: Evidence from Romanian
Alexiadou, Artemis	University of Stuttgart	Manner vs. result complementarity in object alternations: a view from the clear-alternation Psych nominalizations with causers and the structure of psych verbs
Anagnostopoulou, Elena	University of Crete	Manner vs. result complementarity in object alternations: a view from the clear-alternation
Armoskaite, Solveiga	Carleton University	Diagnosis: D
Bader, Markus	University of Konstanz	That-trace effects without traces: an experimental investigation
Baker, Mark	Rutgers University	<i>Invited speaker</i> : Agreement and its relationship to case: An example of generative theory and its relationship to linguistic universals
Bayer, Josef	University of Konstanz	That-trace effects without traces: an experimental investigation
Becker, Michael	University of Massachusetts, Amherst	A richer model is not always more accurate: The case of French and Portuguese plurals Russian yer alternations are governed by the grammar
Bjorkman, Bronwyn M.	Northeastern University	In search of (im)perfection: The illusion of counterfactual aspect
Bochnak, M. Ryan	University of Chicago	The non-universal status of degrees: Evidence from Washo
Braver, Aaron	Rutgers University	The perception of incompletely neutralized /t/ and /d/ flaps in American English
Brentari, Diane	Purdue University	Coarticulation in ASL fingerspelling
Burnett, Heather	UCLA/École normale supérieure, Paris	From quantification and intensification to slack regulation: Adjectival "all"
Butler, Lindsay Kay	University of Arizona	Non-Number plurals
Choi, Jaehoon	University of Arizona	Pro-drop in pronoun-noun constructions
Clemens, Lauren Eby	Harvard University	A richer model is not always more accurate: the case of French and Portuguese plurals
Cowper, Elizabeth	University of Toronto	Syntactic change and the cartography of syntactic structures

<b>Presenter</b>	<b>Affiliation</b>	<b>Title</b>
Di Sciullo, Anna Maria	Université du Québec à Montréal	Third factor in the development of P
Dresher, Elan	University of Toronto	Contrastive features and microvariation in vowel harmony
Fruehwald, Josef	University of Pennsylvania	Sociolinguistic data can be used as phonological evidence
Gallagher, Gillian	New York University	Speaker knowledge of laryngeal phonotactics in Cochabamba Quechua
Georgi, Doreen	University of Leipzig	Local person portmanteaux and hierarchy effects: A unified approach
Gillon, Carrie	Arizona State University	Diagnosis: D
Gouskova, Maria	New York University	Russian yer alternations are governed by the grammar
Gruber, Bettina	Utrecht University	Universals and variation in indexical pronouns
Haeussler, Jana	University of Potsdam	That-trace effects without traces: an experimental investigation
Hall, Daniel Currie	Saint Mary's University/ University of Toronto	Labial place in phonology: Universal and variable
Halpert, Claire	MIT	Syntactic change and the cartography of syntactic structures
		In search of (im)perfection: The illusion of counterfactual aspect
Hartman, Jeremy	MIT	Structural case and the nature of vP in Zulu
		Parallel movement and (non-)intervention by experiencers
Hill, Virginia	University of New Brunswick	The Case of A-bar ECM: Evidence from Romanian
Hinterwimmer, Stefan	University of Osnabrueck	Adverbial quantifiers quantify over events
Imanishi, Yusuke	MIT	How to merge possessor WH in Kaqchikel (Mayan): A non-uniform merge of argument WH
Iordachioaia, Gianina	University of Stuttgart	Psych Nominalizations with Causers and the Structure of Psych Verbs
Irimia, Monica	University of Toronto	How to turn into a resultative
Kang, Chorong	Seoul National University	Dynamicity in sub-extraction phenomena
Keane, Jonathan	University of Chicago	Coarticulation in ASL fingerspelling
Keine, Stefan	University of Massachusetts, Amherst	Long-distance agreement and movement: Evidence from Hindi
Ko, Heejeong	Seoul National University	Dynamicity in sub-extraction phenomena
Koev, Todor	Rutgers University	Temporal and grounding properties of appositive relative clauses
Legate, Julie Anne	University of Pennsylvania	Under-inheritance
Linares-Scarcarieau, Carlo	Rutgers University	The EPP-property as an anti-c-command condition
Mahajan, Anoop	UCLA	Toward a derivational typology
Martin, Fabienne	Universität Stuttgart	On the argument structure of verbs with bi- and mono-eventive uses
Martinovic, Martina	University of Chicago	The subject/non-subject asymmetry in Wolof
Matthewson, Lisa	University of British Columbia	<i>Invited speaker</i> : How (not) to uncover cross-linguistic variation
McKinney-Bock, Katherine	University of Southern California	An argument for interval semantics of gradable adjectives
McNabb, Yaron	University of Chicago	Hebrew definite marking as post-syntactic local dislocation
Minor, Serge	CASTL, University of Tromsø	Controlling the hidden restrictor: A puzzle with control in Russian
Miozzo, Michele	Cambridge University / Johns Hopkins University	Converging evidence from cognitive neuropsychology for the semantic function of Pred
Moore-Cantwell, Claire	University of Massachusetts, Amherst	Over- and under-generalization in learning derivational morphology
Moulton, Keir	McGill University/UCLA	What covaries in backward variable binding
Nevins, Andrew	University College London	A richer model is not always more accurate: the case of French and Portuguese plurals
Nicolis, Marco	Université du Québec à Montréal	Third factor in the development of P
Nonato, Rafael	MIT	Clause-chaining is coordination

<b>Presenter</b>	<b>Affiliation</b>	<b>Title</b>
Orfitelli, Robyn	University of California, Los Angeles	Argument intervention and typological variation in A-movement acquisition
Ouwayda, Sarah	University of Southern California	Cardinals, agreement, and interpretation
Oxford, Will	University of Toronto	A contrast-based model of merger
Paul, Ileana	University of Western Ontario	Wide-scoping bare nouns in Malagasy
Pesetsky, David	MIT	<i>Invited speaker</i> : Dependent Case as Binding Theory
Radkevich, Nina	Harvard University	On locality in contextual allomorphy: Evidence from Mayan
Rapp, Brenda	Johns Hopkins University	Converging evidence from cognitive neuropsychology for the semantic function of Pred
Rawlins, Kyle	Johns Hopkins University	Converging evidence from cognitive neuropsychology for the semantic function of Pred
Rice, Keren	University of Toronto	<i>Invited speaker</i> : What is universal? Some remarks on featural markedness in phonology
Riggle, Jason	University of Chicago	Coarticulation in ASL fingerspelling
Sailor, Craig	UCLA	Remarks on retorts: Emphatic polarity in English Toward a derivational typology
Salzmann, Martin	University of Leipzig	New evidence for postsyntactic verb cluster formation and a right-branching base order That-trace effects without traces: an experimental investigation
Sanchez, Cristina	Johns Hopkins University	Converging evidence from cognitive neuropsychology for the semantic function of Pred
Sawada, Osamu	Mie University	The meanings of diminutive shifts in Japanese
Schäfer, Florian	Universität Stuttgart	On the argument structure of verbs with bi- and mono-eventive uses
Schueler, David Edward	University of Minnesota, Twin Cities	Adverbial quantifiers quantify over events
Simonenko, Alexandra	McGill University	When uniqueness is “guaranteed”: DEN-omission in Swedish
Staroverov, Peter	Rutgers University	Sonorant extension, transitional vowels, and gesture sharing: an acoustic study of Russian clusters
Tessier, Anne-Michelle	University of Michigan	Error-driven learning in harmonic serialism
Thoms, Gary Stewart	University of Strathclyde/ University of Edinburgh	Lexical mismatches in ellipsis, the identity condition and island amelioration
Torres Bustamante, Teresa	Rutgers University	Mirativity as tense/aspect displacement
Villa-García, Julio	University of Connecticut	The puzzle of the Spanish complementizer system
Wiltschko, Martina	University of British Columbia	<i>Invited speaker</i> : The anatomy of universal categories: developing discovery procedures
Wurmbrand, Susanne	University of Connecticut	QR and selection: Covert evidence for phasehood
Yang, Charles	University of Pennsylvania	A statistical proof that language is grammar-, not usage, based
Yoon, Suwon	University of Chicago	On Embedded Root Phenomena (ERP): ERP in Korean versus V2 in Germanic languages
Yoshida, Masaya	Northwestern University	On some syntactic mismatch in the resolution of clausal ellipses
Yun, Suyeon	MIT	Opacity and serial phonology-morphology interaction in Kyungsang Korean

---

## REVIEWERS

Klaus Abels	Ilaria Frana	Ora Matushansky	Dominique Sportiche
Gabriela Alboiu	Naoki Fukui	Paul Menendez-Benito	Bridget Samuels
Luis Alonso-Ovalle	Carrie Gillon	Armin Mester	Philippe Schlenker
Elena Anagnostopoulou	Heather Goad	Jeff Mielke	David Edward Schueler
Karlos Arregi	Martina Gracanin Yuksek	Shigeru Miyagawa	Carson Schutze
Ana Arregui	Vera Gribanova	Elliott Moreton	Florian Schwarz
Daniel Büring	Jane Grimshaw	Marcin Morzycki	Roger Schwarzschild
Mark Baker	Kleanthes K. Grohmann	Gereon Mueller	Yael Sharvit
Michael Barrie	Valentine Hacquard	Kimiko Nakanishi	Michelle Sheehan
Michael Becker	Daniel Currie Hall	Andrew Nevins	Ivy Sichel
Susana Béjar	Gunnar Ólafur Hansson	Jairo Nunes	Daniel Siddiqi
Rajesh Bhatt	Heidi Harley	Ana Pérez-Leroux	Jennifer L. Smith
Theresa Biberauer	Jeffrey Heinz	Marjorie Pak	Tamina Stephenson
Lev Blumenfeld	Sabine Iatridou	Roumyana Pancheva	Tim Stowell
Jonathan Bobaljik	Tania Ionin	Ileana Paul	Judith Tonhauser
Ellen Broselow	Michela Ippolito	Katya Pertsova	Jeroen van
Benjamin Bruening	Alana Johns	David Pesetsky	Cranenenbroeck
Marie-Hélène Côté	Kyle Johnson	Tyler Peterson	Henk C. van Riemsdijk
Andrew Carnie	Arsalan Kahnemuyipour	Maria Polinsky	Kai von Fintel
Emmanuel Chemla	Shigeto Kawahara	Eric Potsdam	Rachel Walker
Andries Coetzee	Laura Kertz	Mike Putnam	Joel Constance Wallenberg
Ariel Cohen	Alexei Kochetov	Nina Radkevich	Colin Wilson
Jessica Coon	Hilda Koopman	Gillian Ramchand	Martina Wiltschko
Elizabeth Cowper	Ivona Kucerova	Kyle Rawlins	Matthew Wolf
Aniko Csirmaz	Winfried Lechner	Milan Rezac	Susanne Wurmsbrand
M. Cristina Cuervo	Julie Anne Legate	Keren Rice	Charles Yang
Henry Davis	Anna Lubowicz	Marc Richards	Masaya Yoshida
Amy Rose Deal	Anoop Mahajan	Norvin Richards	Hedde Zeijlstra
Hamida Demirdache	Shakuntala Mahanta	Elizabeth Ritter	Kie Zuraw
Marcel den Dikken	Diane Massam	Yves Roberge	Jan-Wouter Zwart
Elan Dresher	Eric Mathieu	Hotze Rullmann	
David Embick	Lisa Matthewson	Jeffrey Runner	

---

## ACKNOWLEDGMENTS

Special thanks to the following individuals and groups:

- Our sponsors:
  - Social Sciences and Humanities Research Council of Canada (Research Conference grant)
  - Linguistics Graduate Course Union (LGCU), University of Toronto
  - LGCU Pop/Coffee Fund
  - Dean of Arts and Science, University of Toronto (Dean's Student Initiatives Fund grant)
- NELS organizing committee:
  - LEAD ORGANIZERS: Alex Motut (Chair), Joanna Chociej, Ailis Cournane, Derek Denis, Monica Irimia, Kenji Oda, Will Oxford
  - Marisa Brook, Richard Compton, Radu Craioveanu, Safieh Moghaddam, Christopher Spahr, Julia Su, Kate Wu
- Faculty support: Susana Bejar, Elizabeth Cowper, Diane Massam, Michela Ippolito, Alexei Kochetov, Ana T. Perez-Leroux, Keren Rice
- Abstract review committee: Derek Denis, Ailis Cournane, Diane Massam, Keren Rice
- Housing volunteers: Elaine Gold, Naomi Nagy, Nicholas Rolle, Christopher Spahr, Michelle St.-Amour
- All of our volunteers and session chairs!